









FAMIGLIA "5", accessori taglia 1, 3

<p>Molla taglia 0</p>  <p>BK50 ML 03 0.5 - 3 bar BK50 ML 06 0.5 - 6 bar BK50 ML 16 0.5 - 16 bar</p>	<p>Molla taglia 1</p>  <p>BK51 ML 03 0.5 - 3 bar BK51 ML 06 0.5 - 6 bar BK51 ML 16 0.5 - 16 bar</p>	<p>Molla taglia 3</p>  <p>BK53 ML 03 0.5 - 3 bar BK53 ML 06 0.5 - 6 bar BK53 ML 16 0.5 - 16 bar</p>	<p>Dado di fissaggio a pannello M20 x 1,5</p>  <p>BK51 DD</p>	<p>Control panel nut M30 x 1,5</p>  <p>BK50 DD</p>	<p>Staffa di montaggio</p>  <p>BK51 SF BK53 SF</p>
<p>Staffa di fissaggio su ghiera</p>  <p>BK51 SP</p>	<p>Auto drain</p>  <p>BK SA BK SA NC</p>	<p>Tazza metallica con scarico</p>  <p>BK51 TMS BK53 TMS</p>			

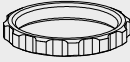
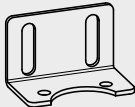
BONESI PNEUMATIK srl
20025 Legnano (MI) - Italy
Via A. Robino 117
Tel. +39 0331.44.80.00
Fax +39 0331.44.80.70
E-mail: info@bonesipneumatik.it
www.bonesipneumatik.com



Serie BK Panoramica (01 / 2016) - Bonesi Pneumatik s.r.l. si riserva il diritto di modificare i dati dichiarati



Unità per il trattamento dell'aria.

Serie BK



Filtro regolatore lubrificatore con manometro

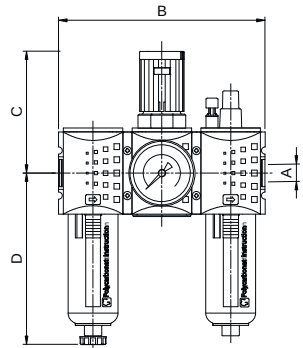

Taglia	Codice	Connessione A	Dimensioni in mm			Portata ¹⁾ l/min
			A	B	C	
0	BK00 FRL 14	G 1/4	129	63	105	500
1	BK01 FRL 14	G 1/4	156	95.5	129.5	1700
1	BK01 FRL 38	G 3/8	156	95.5	129.5	1700
2	BK02 FRL 38	G 3/8	189	110	147	3500
2	BK02 FRL 12	G 1/2	189	110	147	3500
4	BK04 FRL 34	G 3/4	255	137	192	12000
4	BK04 FRL 11	G 1	255	137	192	12000

Filtro regolatore + lubrificatore con manometro

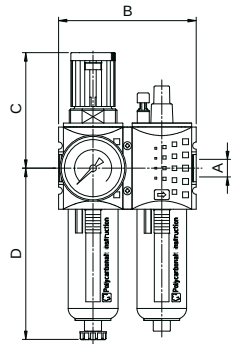

0	BK00 FR+L 14	G 1/4	86	63	105	600
1	BK01 FR+L 14	G 1/4	104	95.5	129.5	1700
1	BK01 FR+L 38	G 3/8	104	95.5	129.5	1700
2	BK02 FR+L 38	G 3/8	126	110	147	3500
2	BK02 FR+L 12	G 1/2	126	110	147	3500
4	BK04 FR+L 34	G 3/4	170	137	192	12000
4	BK04 FR+L 11	G 1	170	137	192	12000

Filtro regolatore con manometro

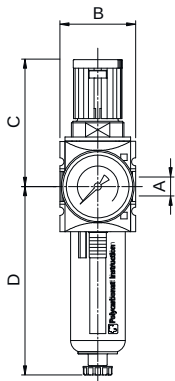

0	BK00 FR 14	G 1/4	43	63	105	1000
1	BK01 FR 14	G 1/4	52	95.5	129.5	2200
1	BK01 FR 38	G 3/8	52	95.5	129.5	2600
2	BK02 FR 38	G 3/8	63	110	147	4300
2	BK02 FR 12	G 1/2	63	110	147	5200
4	BK04 FR 34	G 3/4	85	137	192	14000
4	BK04 FR 11	G 1	85	137	192	14000

Lubrificatore

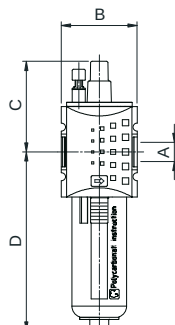

0	BK00 L 14	G 1/4	43	58	98	1400
1	BK01 L 14	G 1/4	52	62.2	123	2800
1	BK01 L 38	G 3/8	52	62.2	123	2800
2	BK02 L 38	G 3/8	63	69.7	137.5	8000
2	BK02 L 12	G 1/2	63	69.7	137.5	8000
4	BK04 L 34	G 3/4	85	87.9	182.8	13000
4	BK04 L 11	G 1	85	87.9	182.8	13000

Filtro 5 µm

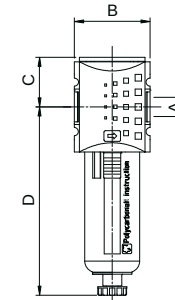

Taglia	Codice	Connessioni A	Dimensioni in mm			Portata ¹⁾ l/min
			A	B	C	
0	BK00 F 14	G 1/4	43	27	105	950
1	BK01 F 14	G 1/4	52	34	130	2200
1	BK01 F 38	G 3/8	52	34	130	2400
2	BK02 F 38	G 3/8	63	42.5	147	3500
2	BK02 F 12	G 1/2	63	42.5	147	3500
4	BK04 F 34	G 3/4	85	58	192	8000
4	BK04 F 11	G 1	85	58	192	8200

Prefiltro 0.3 µm

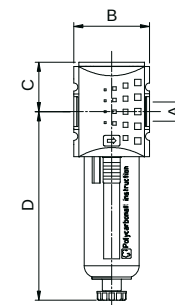

0	BK00 PF 14	G 1/4	43	27	105	350 ²⁾
1	BK01 PF 14	G 1/4	52	34	128.5	500
1	BK01 PF 38	G 3/8	52	34	128.5	500
2	BK02 PF 38	G 3/8	63	42.5	147	580
2	BK02 PF 12	G 1/2	63	42.5	147	580
4	BK04 PF 34	G 3/4	85	63	192	1500
4	BK04 PF 11	G 1	85	63	192	1500

Filtro fine 0.01 µm, contenuto rimanente in olio < 0.01 mg/m³

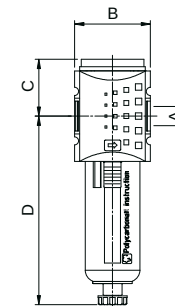

0	BK00 FF 14	G 1/4	43	27	105	350 ³⁾
1	BK01 FF 14	G 1/4	52	38	130.5	350
1	BK01 FF 38	G 3/8	52	38	130.5	350
2	BK02 FF 38	G 3/8	63	48	147	500
2	BK02 FF 12	G 1/2	63	48	147	500
4	BK04 FF 34	G 3/4	85	63	192	1500
4	BK04 FF 11	G 1	85	63	192	1500

Filtro a carboni attivi ¹⁾ contenuto rimanente in olio < 0.005 mg/m³

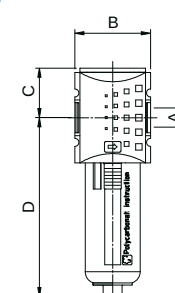

0	BK00 FFC 14	G 1/4	43	27	98	600 ⁴⁾
1	BK01 FFC 14	G 1/4	52	34	124	650
1	BK01 FFC 38	G 3/8	52	34	124	650
2	BK02 FFC 38	G 3/8	63	43	141	1300
2	BK02 FFC 12	G 1/2	63	43	141	1300
4	BK04 FFC 34	G 3/4	85	58	184	2000
4	BK04 FFC 11	G 1	85	58	184	2000

1) p₁ = 10 bar; p₂ = 6.3 bar

1) p₁ = 6 bar 2) KPFI a p₁ = 6 bar e calo di pressione Δp = 0.02 bar 3) KCFI a p₁ = 6 bar e calo di pressione Δp = 0.09 bar 4) KAFI a p₁ = 6 bar e calo di pressione Δp = 0.2 bar

Regolatore con manometro

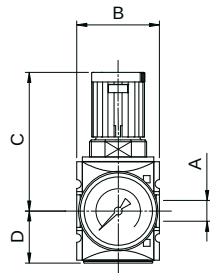

Taglia	Codice	Conessioni		Dimensioni in mm				Portata l/min
		A		B	C	D		
0	BK00 R 14	G 1/4		43	63	25	1000	
1	BK01 R 14	G 1/4		52	95.5	33	2200	
1	BK01 R 38	G 3/8		52	95.5	33	2600	
2	BK02 R 38	G 3/8		63	110	39.5	4300	
2	BK02 R 12	G 1/2		63	110	39.5	5100	
4	BK04 R 34	G 3/4		85	137	54	14000	
4	BK04 R 11	G 1		85	137	54	14000	

Regolatore con manometro incorporato nella manopola
campo di regolazione 0,5 ÷ 10 bar

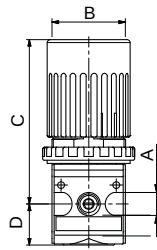

0	BK70 RMI 14 *	G 1/4		40	87	22	1100
0	BK70 RMI 14 **	G 1/4		40	102	22	1100
1	BK71 RMI 14 **	G 1/4		48	107	27	1500
1	BK71 RMI 38 **	G 3/8		48	107	27	1500

* manometro Ø 25 mm.
** manometro Ø 40 mm.

Regolatore di precisione

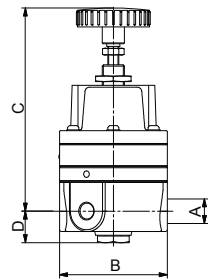

1	BK51 R 14P X	G 1/4		58	109	17	900
1	BK51 R 14P X N		1/4 NPT	58	109	17	900

indicare al posto della "X" la pressione massima di regolazione (2, 4, 10 bar), se non indicato il campo di regolazione è 0,05 ÷ 7 bar

Regolatore di precisione ad elevato relieving

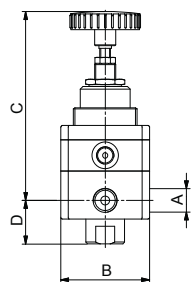

1	BK51 R 14PP	G 1/4		50	106	25	1250
---	-------------	-------	--	----	-----	----	------

campo di regolazione è 0,05 ÷ 8 bar

Regolatore di precisione ad elevata portata

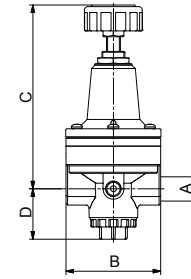

Taglia	Codice	Conessioni		Dimensioni in mm			Portata l/min
		A		B	C	D	
3	BK53 R 38P X	G 3/8		82	160	44	6000
3	BK53 R 12P X	G 1/2		82	160	44	6500

indicare al posto della "X" la pressione massima di regolazione (3, 5, 10 bar), se non indicato il campo di regolazione è 0,05 – 7 bar

Regolatore di alta precisione corpo in tecnopolimero

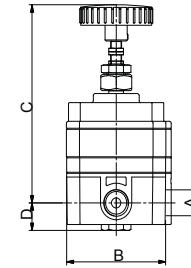

1	BK51 PR 14P X	G 1/4		57	100	14	400
---	---------------	-------	--	----	-----	----	-----

indicare al posto della "X" la pressione massima di regolazione (4 bar), se non indicato il campo di regolazione è 0,1 – 8 bar

Valvola 3/2 a controllo elettrico

voltaggio standard 24 Vdc, altri voltaggi disponibili a richiesta

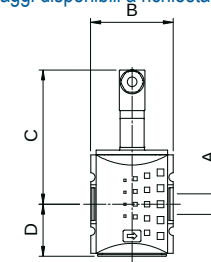

0	BK00 ECV 14	G 1/4		43	93	36.6	2000
1	BK01 ECV 14	G 1/4		52	84.5	32.8	2000
1	BK01 ECV 38	G 3/8		52	84.5	32.8	2000
2	BK02 ECV 38	G 3/8		63	93.5	56.5	4300
2	BK02 ECV 12	G 1/2		63	93.5	56.5	4300
4	BK04 ECV 34	G 3/4		85	110.9	102.3	12500
4	BK04 ECV 11	G 1		85	110.9	102.3	12500

Valvola 3/2 a controllo pneumatico

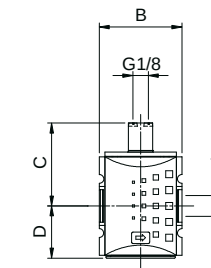

0	BK00 PCV 14	G 1/4		43	60.1	36.62	2000
1	BK01 PCV 14	G 1/4		52	52	33	2000
1	BK01 PCV 38	G 3/8		52	52	33	2000
2	BK02 PCV 38	G 3/8		63	60.8	56.5	4300
2	BK02 PCV 12	G 1/2		63	60.8	56.5	4300
4	BK04 PCV 34	G 3/4		85	78.2	67	12500
4	BK04 PCV 11	G 1		85	78.2	67	12500

Valvola per avviamento progressivo regolabile

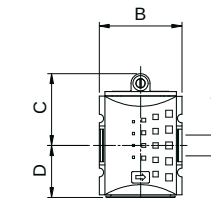

0	BK00 AP 14	G 1/4		48	53	28	2000
1	BK01 AP 14	G 1/4		52	45	33	1900
1	BK01 AP 38	G 3/8		52	45	33	1900
2	BK02 AP 38	G 3/8		63	53.5	58	4400
2	BK02 AP 12	G 1/2		63	53.5	58	4400
4	BK04 AP 34	G 3/4		85	58.2	54	10000
4	BK04 AP 11	G 1		85	58.2	54	10000

Valvola a sfera con blocco di sicurezza

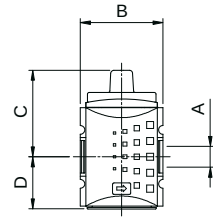

Taglia	Codice	Conessioni		Dimensioni in mm				Portata l/min
		A		B	C	D		
0	BK00 VS 14	G 1/4		43	51	25	2600	
1	BK01 VS 14	G 1/4		52	54,3	33	1900	
1	BK01 VS 38	G 3/8		52	54,3	33	1900	
2	BK02 VS 38	G 3/8		63	70.5	56.5	5000	
2	BK02 VS 12	G 1/2		63	70.5	56.5	5000	
4	BK04 VS 34	G 3/4		85	93.7	51	14000	
4	BK04 VS 11	G 1		85	93.7	51	14000	

Blocchetto di derivazione a T

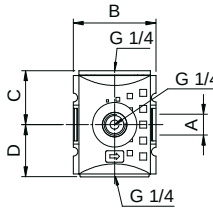

0	BK00 DT 14	G 1/4		43	28,5	25	2700
1	BK01 DT 14	G 1/4		52	34.5	31	2700
1	BK01 DT 38	G 3/8		52	34.5	31	3600
2	BK02 DT 38	G 3/8		63	43	37.5	7250
2	BK02 DT 12	G 1/2		63	43	37.5	7250
4	BK04 DT 34	G 3/4		85	58.5	51	18000
4	BK04 DT 11	G 1		85	58.5	51	18000

Valvola di non ritorno

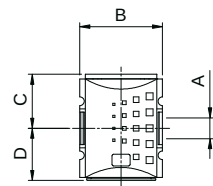

0	BK00 UD 14	G 1/4		43	27	39	800
1	BK01 UD 14	G 1/4		52	34	33	1250
1	BK01 UD 38	G 3/8		52	34	33	1250
2	BK02 UD 38	G 3/8		63	43	37.5	4500
2	BK02 UD 12	G 1/2		63	43	37.5	4500

Filtro regolatore di precisione

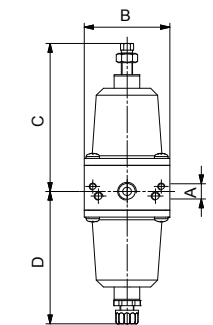

1	BK51 FR 14P X	G 1/4		60	108	96	750
1	BK51 FR 14P X N		1/4 NPT	60	108	96	750

indicare al posto della "X" la pressione massima di regolazione (2, 4, 10 bar), se non indicato il campo di regolazione è 0,05 – 7 bar

FAMIGLIA "0" accessori taglia 0, 1, 2, 4

Molla taglia 0



BK00 ML 04 0.2 – 4 bar
BK00 ML 08 0.5 – 8 bar
BK00 ML 10 0.5 – 10 bar

Molla taglia 1



BK01 ML 01 0.1 – 1 bar
BK01 ML 02 0.1 – 2 bar
BK01 ML 04 0.2 – 4 bar
BK01 ML 08 0.5 – 8 bar
BK01 ML 10 0.5 – 10 bar
BK01 ML 16 0.5 – 16 bar

Molla taglia 2



BK02 ML 01 0.1 – 1 bar
BK02 ML 02 0.1 – 2 bar
BK02 ML 04 0.2 – 4 bar
BK02 ML 08 0.5 – 8 bar
BK02 ML 10 0.5 – 10 bar
BK02 ML 16 0.5 – 16 bar

Molla taglia 4



BK04 ML 01 0.1 – 1 bar
BK04 ML 02 0.1 – 2 bar
BK04 ML 04 0.2 – 4 bar
BK04 ML 08 0.5 – 8 bar
BK04 ML 10 0.5 – 10 bar
BK04 ML 16 0.5 – 16 bar

Ghiera fissaggio a pannello

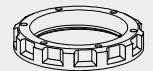

BK00 GH
BK01 GH
BK02 GH
BK04 GH

Staffa di fissaggio per installazione a pannello

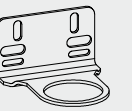

BK00 SP
BK01 SP
BK02 SP

Staffa di montaggio



BK00 SF
BK01 SF
BK02 SF
BK04 SF

Kit di assemblaggio per installazione a muro

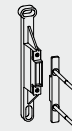

BK00 SM
BK01 SM
BK02 SM
BK04 SM

Kit di assemblaggio

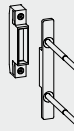

BK00 SS
BK01 SS
BK02 SS
BK04 SS

Tazza metallica con indicatore di livello e scarico



BK00 TZM (senza indicatore di livello)
BK01 TZM
BK02 TZM
BK04 TZM

Manometro



M 5 04 1/4
M 5 10 1/4
M 5 12 1/4
M 6 04 1/4
M 6 10 1/4
M 6 12 1/4

Manometro taglia 0 quadrato

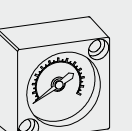

M Q 06
M Q 12

Scarico automatico



BK SA
BK SA NC

Elettropilota

24 V=; 24 V/50 Hz;
115 V/50 Hz; 230 V/50 Hz



BOBF024AC
BOBF110AC
BOBF220AC
+
CNN3

Lucchetto

Chiusura tipo E11
Chiusura tipo G1663



BK LK 1
BK LK 2

Pressostato regolabile

Connessione 1/4" G
Campo di regolazione 1÷12 bar
Contatti in scambio (comune, NA, NC)
Carico massimo 0,5 A a 250 VAc
Attacco elettrico DIN43650
Protezione elettrica IP65



F4 SL1 M2