

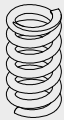







Accessories for size 0, 1, 3 (type BK5...)

<p>Spring for sz. 0</p>  <p>BK50 ML 03 0.5 – 3 bar BK50 ML 06 0.5 – 6 bar BK50 ML 16 0.5 – 16 bar</p>	<p>Spring for sz. 1</p>  <p>BK51 ML 03 0.5 – 3 bar BK51 ML 06 0.5 – 6 bar BK51 ML 16 0.5 – 16 bar</p>	<p>Spring for sz. 3</p>  <p>BK53 ML 03 0.5 – 3 bar BK53 ML 06 0.5 – 6 bar BK53 ML 16 0.5 – 16 bar</p>	<p>Panel mounting nut M20 x 1,5</p>  <p>BK51 DD</p>	<p>Panel nut BG0 M30 x 1,5</p>  <p>BK50 DD</p>	<p>Mounting bracket</p>  <p>BK51 SF BK53 SF</p>
<p>Mounting bracket with nut</p>  <p>BK51 SP</p>	<p>Automatic drain</p>  <p>BK SA BK SA NC</p>	<p>Metal tank with drain</p>  <p>BK51 TMS BK53 TMS</p>			

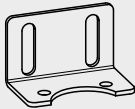
BONESI PNEUMATIK srl
20025 Legnano (MI) - Italy
Via A. Robino 117
Tel. +39 0331.44.80.00
Fax +39 0331.44.80.70
E-mail: info@bonesipneumatik.it
www.bonesipneumatik.com



BK Series Overview (01 / 2016)



FRL Groups

BK Series



Filter + Regulator + Lubricator

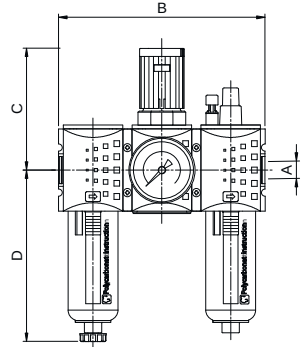

Size	Code	Connection A	Dimensions (mm.)			Flow Rate ¹⁾ l / min.
			B	C	D	
0	BK00 FRL 14	G 1/4	129	63	105	500
1	BK01 FRL 14	G 1/4	156	95.5	129.5	1700
1	BK01 FRL 38	G 3/8	156	95.5	129.5	1700
2	BK02 FRL 38	G 3/8	189	110	147	3500
2	BK02 FRL 12	G 1/2	189	110	147	3500
4	BK04 FRL 34	G 3/4	255	137	192	12000
4	BK04 FRL 11	G 1	255	137	192	12000

Filter-Regulator + Lubricator

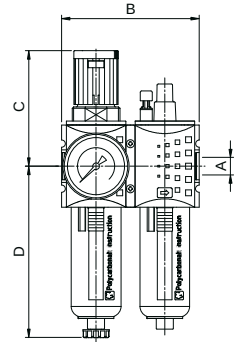

0	BK00 FR+L 14	G 1/4	86	63	105	600
1	BK01 FR+L 14	G 1/4	104	95.5	129.5	1700
1	BK01 FR+L 38	G 3/8	104	95.5	129.5	1700
2	BK02 FR+L 38	G 3/8	126	110	147	3500
2	BK02 FR+L 12	G 1/2	126	110	147	3500
4	BK04 FR+L 34	G 3/4	170	137	192	12000
4	BK04 FR+L 11	G 1	170	137	192	12000

Filter-Regulator

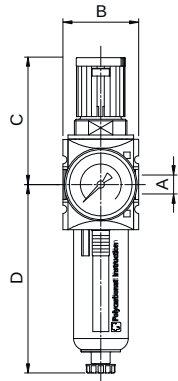

0	BK00 FR 14	G 1/4	43	63	105	1000
1	BK01 FR 14	G 1/4	52	95.5	129.5	2200
1	BK01 FR 38	G 3/8	52	95.5	129.5	2600
2	BK02 FR 38	G 3/8	63	110	147	4300
2	BK02 FR 12	G 1/2	63	110	147	5200
4	BK04 FR 34	G 3/4	85	137	192	14000
4	BK04 FR 11	G 1	85	137	192	14000

Lubricator

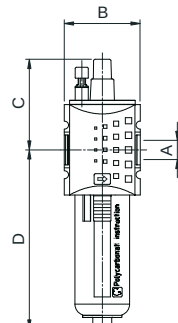

0	BK00 L 14	G 1/4	43	58	98	1400
1	BK01 L 14	G 1/4	52	62.2	123	2800
1	BK01 L 38	G 3/8	52	62.2	123	2800
2	BK02 L 38	G 3/8	63	69.7	137.5	8000
2	BK02 L 12	G 1/2	63	69.7	137.5	8000
4	BK04 L 34	G 3/4	85	87.9	182.8	13000
4	BK04 L 11	G 1	85	87.9	182.8	13000

Filter 5 µm

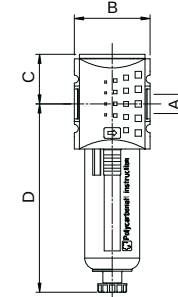

Size	Code	Connection A	Dimensions (mm.)			Flow Rate ¹⁾ l / min.
			B	C	D	
0	BK00 F 14	G 1/4	43	27	105	950
1	BK01 F 14	G 1/4	52	34	130	2200
1	BK01 F 38	G 3/8	52	34	130	2400
2	BK02 F 38	G 3/8	63	42.5	147	3500
2	BK02 F 12	G 1/2	63	42.5	147	3500
4	BK04 F 34	G 3/4	85	58	192	8000
4	BK04 F 11	G 1	85	58	192	8200

Pre-Filter 0.3 µm

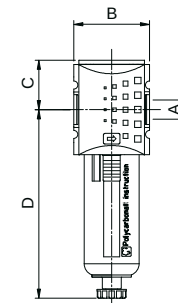

0	BK00 PF 14	G 1/4	43	27	105	350 ²⁾
1	BK01 PF 14	G 1/4	52	34	128.5	500
1	BK01 PF 38	G 3/8	52	34	128.5	500
2	BK02 PF 38	G 3/8	63	42.5	147	580
2	BK02 PF 12	G 1/2	63	42.5	147	580
4	BK04 PF 34	G 3/4	85	63	192	1500
4	BK04 PF 11	G 1	85	63	192	1500

Fine Filter 0.01 µm, remaining oil content < 0.01 mg/m³

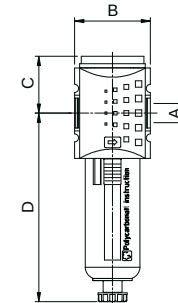

0	BK00 FF 14	G 1/4	43	27	105	350 ³⁾
1	BK01 FF 14	G 1/4	52	38	130.5	350
1	BK01 FF 38	G 3/8	52	38	130.5	350
2	BK02 FF 38	G 3/8	63	48	147	500
2	BK02 FF 12	G 1/2	63	48	147	500
4	BK04 FF 34	G 3/4	85	63	192	1500
4	BK04 FF 11	G 1	85	63	192	1500

**Activated carbon Filter
remaining oil content < 0.005 mg/m³**

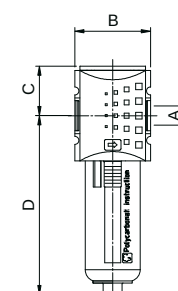

0	BK00 FFC 14	G 1/4	43	27	98	600 ⁴⁾
1	BK01 FFC 14	G 1/4	52	34	124	650
1	BK01 FFC 38	G 3/8	52	34	124	650
2	BK02 FFC 38	G 3/8	63	43	141	1300
2	BK02 FFC 12	G 1/2	63	43	141	1300
4	BK04 FFC 34	G 3/4	85	58	184	2000
4	BK04 FFC 11	G 1	85	58	184	2000

1) p₁ = 10 bar; p₂ = 6.3 bar

1) p₁ = 6 bar 2) KPFI at p = 6 bar and pressure drop Δp = 0.02 bar 3) KCFI at p = 6 bar and pressure drop Δp = 0.09 bar 4) KAFI at p = 6 bar and pressure drop Δp = 0.2 bar

Regulator

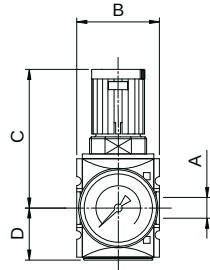

Size	Code	Connection		Dimensions (mm.)			Flow Rate l / min.
		A		B	C	D	
0	BK00 R 14	G 1/4		43	63	25	1000
1	BK01 R 14	G 1/4		52	95.5	33	2200
1	BK01 R 38	G 3/8		52	95.5	33	2600
2	BK02 R 38	G 3/8		63	110	39.5	4300
2	BK02 R 12	G 1/2		63	110	39.5	5100
4	BK04 R 34	G 3/4		85	137	54	14000
4	BK04 R 11	G 1		85	137	54	14000

Regulator with integrated gauge
regulation range 0,5 ÷ 10 bar

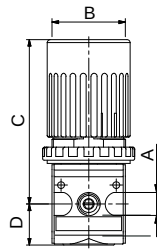

0	BK70 RMI 14 *	G 1/4		40	87	22	1100
0	BK70 RMI 14 **	G 1/4		40	102	22	1100
1	BK71 RMI 14 **	G 1/4		48	107	27	1500
1	BK71 RMI 38 **	G 3/8		48	107	27	1500

* gauge Ø 25 mm.
** gauge Ø 40 mm.

Precision Regulator

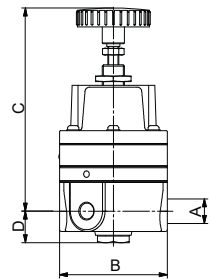

"X": input maximum regulation pressure (2, 4, 10 bar), not specified regulation range: 0,05 ÷ 7 bar

1	BK51 R 14P X	G 1/4		58	109	17	900
1	BK51 R 14P X N		1/4 NPT	58	109	17	900

Precision Regulator with high relieving

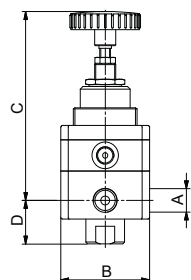

regulation range: 0,05 ÷ 8 bar

1	BK51 R 14PP	G 1/4		50	106	25	1250
---	-------------	-------	--	----	-----	----	------

Precision Regulator with high flow rate

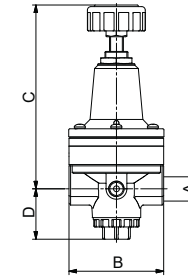

"X": input maximum regulation pressure (3, 5, 10 bar), not specified regulation range: 0,05 ÷ 7 bar

Size	Code	Connection		Dimensions (mm.)			Flow Rate l / min.
		A		B	C	D	
3	BK53 R 38P X	G 3/8		82	160	44	6000
3	BK53 R 12P X	G 1/2		82	160	44	6500

High precision Regulator plastic body

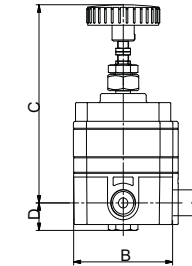

"X": input maximum regulation pressure (4 bar), not specified regulation range: 0,1 ÷ 8 bar

1	BK51 PR 14P X	G 1/4		57	100	14	400
---	---------------	-------	--	----	-----	----	-----

3/2 Valve, electric pilot
standard voltage 24 Vdc, voltages on request

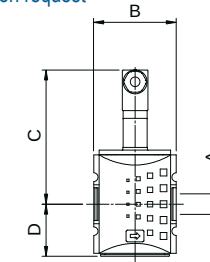

0	BK00 ECV 14	G 1/4		43	93	36.6	2000
1	BK01 ECV 14	G 1/4		52	84.5	32.8	2000
1	BK01 ECV 38	G 3/8		52	84.5	32.8	2000
2	BK02 ECV 38	G 3/8		63	93.5	56.5	4300
2	BK02 ECV 12	G 1/2		63	93.5	56.5	4300
4	BK04 ECV 34	G 3/4		85	110.9	102.3	12500
4	BK04 ECV 11	G 1		85	110.9	102.3	12500

3/2 Valve, pneumatic pilot

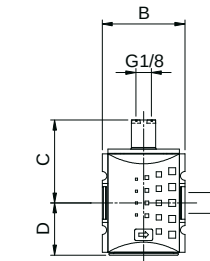

0	BK00 PCV 14	G 1/4		43	60.1	36.62	2000
1	BK01 PCV 14	G 1/4		52	52	33	2000
1	BK01 PCV 38	G 3/8		52	52	33	2000
2	BK02 PCV 38	G 3/8		63	60.8	56.5	4300
2	BK02 PCV 12	G 1/2		63	60.8	56.5	4300
4	BK04 PCV 34	G 3/4		85	78.2	67	12500
4	BK04 PCV 11	G 1		85	78.2	67	12500

Soft starting adjustable Valve

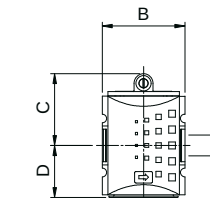

0	BK00 AP 14	G 1/4		48	53	28	2000
1	BK01 AP 14	G 1/4		52	45	33	1900
1	BK01 AP 38	G 3/8		52	45	33	1900
2	BK02 AP 38	G 3/8		63	53.5	58	4400
2	BK02 AP 12	G 1/2		63	53.5	58	4400
4	BK04 AP 34	G 3/4		85	58.2	54	10000
4	BK04 AP 11	G 1		85	58.2	54	10000

Ball Valve lockable with padlock

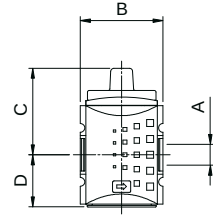

Size	Code	Connection		Dimensions (mm.)				Flow Rate l/min.
		A		B	C	D		
0	BK00 VS 14	G 1/4		43	51	25	2600	
1	BK01 VS 14	G 1/4		52	54,3	33	1900	
1	BK01 VS 38	G 3/8		52	54,3	33	1900	
2	BK02 VS 38	G 3/8		63	70.5	56.5	5000	
2	BK02 VS 12	G 1/2		63	70.5	56.5	5000	
4	BK04 VS 34	G 3/4		85	93.7	51	14000	
4	BK04 VS 11	G 1		85	93.7	51	14000	

T-Distributor

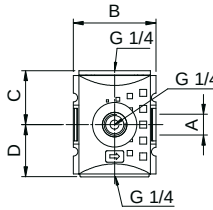

0	BK00 DT 14	G 1/4		43	28,5	25	2700
1	BK01 DT 14	G 1/4		52	34.5	31	2700
1	BK01 DT 38	G 3/8		52	34.5	31	3600
2	BK02 DT 38	G 3/8		63	43	37.5	7250
2	BK02 DT 12	G 1/2		63	43	37.5	7250
4	BK04 DT 34	G 3/4		85	58.5	51	18000
4	BK04 DT 11	G 1		85	58.5	51	18000

Non return Valve

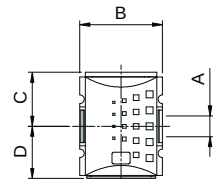

0	BK00 UD 14	G 1/4		43	27	39	800
1	BK01 UD 14	G 1/4		52	34	33	1250
1	BK01 UD 38	G 3/8		52	34	33	1250
2	BK02 UD 38	G 3/8		63	43	37.5	4500
2	BK02 UD 12	G 1/2		63	43	37.5	4500

Precision Filter-Regulator

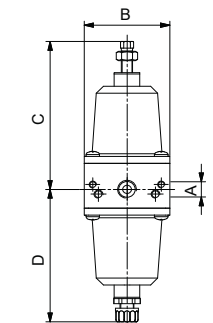

1	BK51 FR 14P X	G 1/4		60	108	96	750
1	BK51 FR 14P X N		1/4 NPT	60	108	96	750

"X": input maximum regulation pressure (2, 4, 10 bar), not specified regulation range: 0,05 ÷ 7 bar

Accessories for size 0, 1, 2, 4 (type BK0....)

<p>Spring for sz. 0</p> <p>BK00 ML 04 0.2 – 4 bar BK00 ML 08 0.5 – 8 bar BK00 ML 10 0.5 – 10 bar</p>	<p>Spring for sz. 1</p> <p>BK01 ML 01 0.1 – 1 bar BK01 ML 02 0.1 – 2 bar BK01 ML 04 0.2 – 4 bar BK01 ML 08 0.5 – 8 bar BK01 ML 10 0.5 – 10 bar BK01 ML 16 0.5 – 16 bar</p>	<p>Spring for sz. 2</p> <p>BK02 ML 01 0.1 – 1 bar BK02 ML 02 0.1 – 2 bar BK02 ML 04 0.2 – 4 bar BK02 ML 08 0.5 – 8 bar BK02 ML 10 0.5 – 10 bar BK02 ML 16 0.5 – 16 bar</p>	<p>Spring for sz. 4</p> <p>BK04 ML 01 0.1 – 1 bar BK04 ML 02 0.1 – 2 bar BK04 ML 04 0.2 – 4 bar BK04 ML 08 0.5 – 8 bar BK04 ML 10 0.5 – 10 bar BK04 ML 16 0.5 – 16 bar</p>	<p>Panel ring nut</p> <p>BK00 GH BK01 GH BK02 GH BK04 GH</p>	<p>Bracket for panel mounting</p> <p>BK00 SP BK01 SP BK02 SP</p>
<p>Mounting bracket</p> <p>BK00 SF BK01 SF BK02 SF BK04 SF</p>	<p>Assembly kit for wall mounting</p> <p>BK00 SM BK01 SM BK02 SM BK04 SM</p>	<p>Assembly</p> <p>BK00 SS BK01 SS BK02 SS BK04 SS</p>	<p>Metal tank with drain and indicator</p> <p>BK00 TZM (senza indicatore di livello) BK01 TZM BK02 TZM BK04 TZM</p>	<p>Gauge</p> <p>M 5 04 1/4 M 5 10 1/4 M 5 12 1/4 M 6 04 1/4 M 6 10 1/4 M 6 12 1/4</p>	<p>Gauge (for size 0 only)</p> <p>M Q 06 M Q 12</p>
<p>Automatic Drain</p> <p>BK SA BK SA NC</p>	<p>Electrical Pilot 24 V=; 24 V/50 Hz; 115 V/50 Hz; 230 V/50 Hz</p> <p>BOBF024AC BOBF110AC BOBF220AC + CNN3</p>	<p>Padlock E11 type G1663 type</p> <p>BK LK 1 BK LK 2</p>			